

# 1700 Series

## Fire-Labeled Electric Strikes



1704



1714



### Description

DynaLock 1700 Series Fire-Labeled Electric Strikes accommodate cylindrical, centerline mortise, and narrow-line aluminum locksets, along with mortise exit devices, with up to 3/4" latch projection (non-Pullman type). An enlarged latch cavity width allows compatibility with 3-piece, anti-friction latches. Fail-secure lock mode is standard and 12V and 24V models accept AC/DC input. All models are fully reversible for left or right-hand doors and standard mounting tabs and installation fasteners are included. Radius or square corner, US32D Stainless Steel, ANSI 4-7/8" x 1-1/4" faceplates are available. All models are Fire-Labeled, UL 10C (1-1/2 hr) and UL 1034 Burglary-resistant.

Typical applications include fire rated doors in most commercial, industrial, institutional, retail, health care facilities and office complexes.

### Standard Features

- Fire-Labeled - UL10C (1-1/2Hr.)
- UL 1034 Burglary Resistant
- US32D Stainless Steel Face Plate
- Accommodates 3/4" Latch Projection (Non-Pullman)
- 12V and 24V Models Accept AC/DC Input
- Static Strength: 1,500Lbs
- Endurance Rating: 250,000 Cycles
- Great For Heavy-Duty Applications
- Non-Polarity Sensitive Coil
- Unique Anti-Vibration Design
- 3 Year Limited Warranty

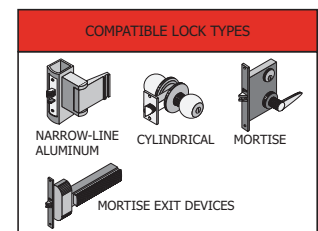
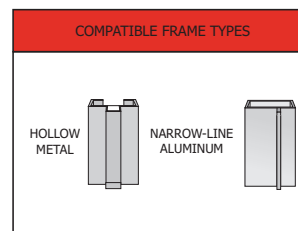

# 1700 Series Fire-Labeled Electric Strikes Specifications

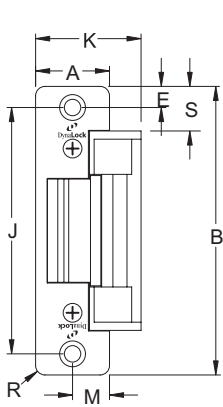

MODEL# 1704

PROFILE MEASUREMENT	1704 INCHES	1704 DECIMAL	1704 METRIC (mm)
A	1-1/4	1.250	31.75
B	4-7/8	4.875	123.83
E	3/8	0.375	9.53
J	4-1/8	4.125	104.78
K	1-3/4	1.750	44.45
M	5/8	0.625	15.88
R	5/32	0.156	3.97
S	3/4	0.750	19.05

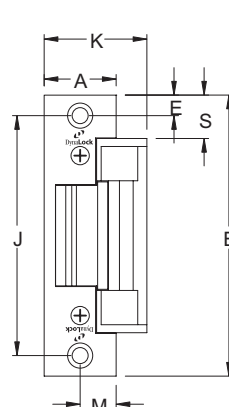

MODEL# 1714

PROFILE MEASUREMENT	1714 INCHES	1714 DECIMAL	1714 METRIC (mm)
A	1-1/4	1.250	31.75
B	4-7/8	4.875	123.83
E	3/8	0.375	9.53
J	4-1/8	4.125	104.78
K	1-3/4	1.750	44.45
M	5/8	0.625	15.88
R	N/A	N/A	N/A
S	3/4	0.750	19.05

MODEL	MODE	VOLTAGE	CURRENT	DUTY	SOUND	AMPS	OHMS
17XX-12	FAIL LOCKED	12V	AC	INTERMITTENT	BUZZ	0.15	61
		12V	DC	CONTINUOUS	SILENT	0.20	61
17XX-24	FAIL LOCKED	24V	AC	INTERMITTENT	BUZZ	0.07	215
		24V	DC	CONTINUOUS	SILENT	0.11	215

\*Ratings are based on maximum current draw at +10°C and include initial power-up current draw. Nominal resistance at +25°C ± % tolerance.  
 NOTE: XX = Faceplate Code. Intermittent Duty = Energized less than 1 min. Continuous Duty = Energized 1 min. or more. Duty Ratio 1:5.  
 Dimensions shown below with 04 faceplate.

PROFILES													
MEASUREMENTS	C	D	F	G	H	L	N	P	Q	T	U	V	W
FRACTIONAL INCHES	3-3/8	7/8	1/8	1-3/4	9/16	1-1/2	13/32	13/32	3-13/16	1-7/8	15/16	9/16	21/32
DECIMAL INCHES	3.375	0.875	0.125	1.750	0.563	1.500	0.406	0.406	3.813	1.875	0.938	0.563	0.656
METRIC mm	85.73	22.23	3.18	44.45	14.29	38.10	10.32	10.32	96.84	47.63	23.81	14.29	16.67

NOTE: Not to scale. Specifications are subject to change without notice.

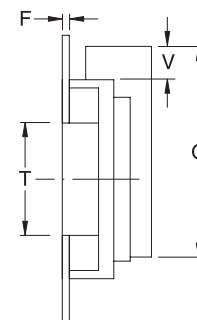
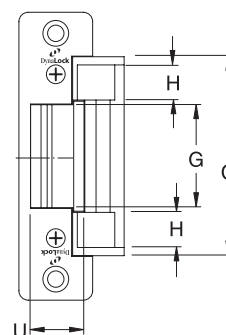
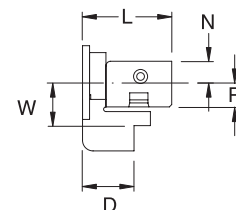

**DYNALOCK CORPORATION**  
 705 EMMETT STREET / PO BOX 2728  
 BRISTOL, CT 06011-2728  
 PHONE: 877-DYNALOCK / FAX: 860-585-0338  
 E-MAIL: INFO@DYNALOCK.COM  
 WEBSITE: WWW.DYNALOCK.COM

Featuring  
  
**DynaLife**<sup>®</sup>  
 Lifetime Warranty